

Como Park Road

Bennett Road

Union Road 28,500VPD

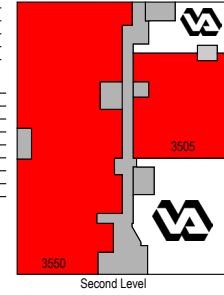
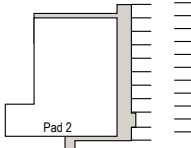
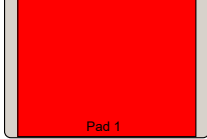

TENANT	SUITE ID	TENANT	SUITE ID	TENANT	SUITE ID
AVAILABLE	PAD 1	U.S. RENAL CARE	13C/D	AVAILABLE	49
BUFFALO VETERAN CENTER	PAD 2	BUFFALO FINANCIAL GROUP	21	AVAILABLE	50-50A
AVAILABLE	1-3	MANAGEMENT OFFICE	22	AVAILABLE	352
AVAILABLE	8 & 8A	GA - JAMESTOWN LUTHERAN	25 - 27	SECURITY OFFICE	360
FITNESS CENTER	4	CONSERVE	28 - 29	VETERAN'S ADMINISTRATION	3500 & 3510
QUEEN CITY CAFE	5 - 6	LEVEL 3	34A	AVAILABLE	3505
HELD'S JANITORIAL SERVICES	7A	EMPIRE STATE COLLEGE	34 - 34B	AVAILABLE	3550
GOVERNMENT LEASE	7, 9, 14-24, 30-33, 350-351	SPECTRUM	37-38; 39-43; 359; PAD 3		
COUNTY OF ERIE DEPARTMENT OF SOCIAL SERVICES	356	NATIONAL FUEL	44		
AVAILABLE	10 - 11	AVAILABLE	45 - 46A		
GSA	12A - 13B	CATHOLIC CHARITIES	47-48		

**AmCap**  
Properties Inc.

**BROOKE STEVENS**  
203-327-2001  
BStevens@AmCap.com

We obtained the information contained herein from sources we believe to be reliable. However, we have not verified its accuracy and make no guarantee, warranty or representation about it. It is submitted subject to the possibility of errors, omissions, change of price, rental or other conditions, prior sale, lease or financing, or withdrawal without notice. All marks displayed on this document are the property of their respective owners.